



eterncivica

izonet
HIDROIZOLACIONI SISTEMI

**ADJUSTABLE FLOOR SUPPORT
FOR DIFFERENT KINDS OF PAVING**

BASIC adjustable floor support

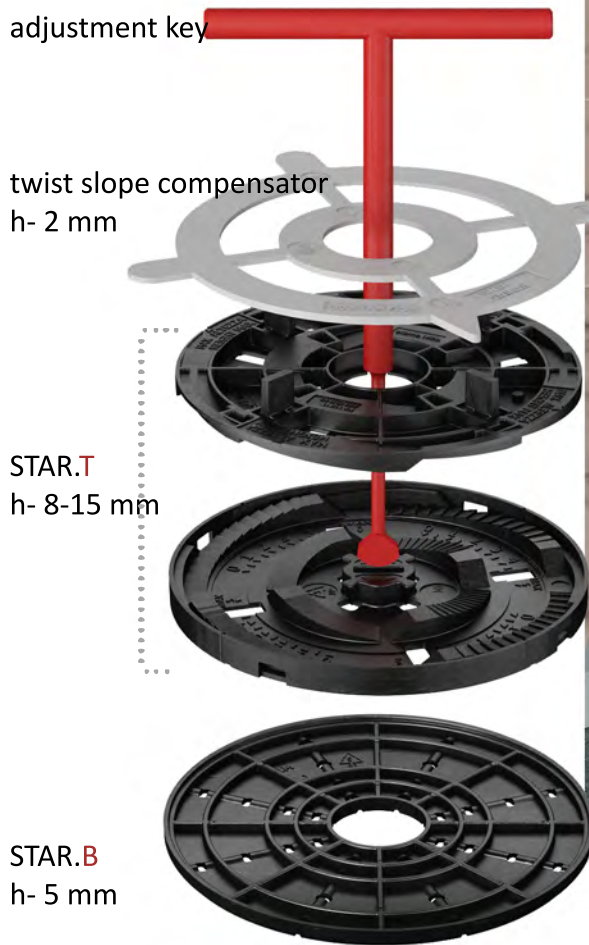

Star.T is initial floor supporter whose height varies from 8 to 15 mm.

Floor support system **Basic** is used for heights from 8 mm to 30 cm.

If you need it to be higher, this can be easily achieved by adding an element **Star.B** which is 5 mm high. A maximum of 3 elements (15cm) can be added.

They are easily and quickly installed, covering old paving or some other kind of substrate, giving the space a completely new atmosphere.

STAR T – height only 10 mm allows system installation even if there is low construction altitude (level).

ETERNO

adjustable floor support

- SE0**
h- 28-38 mm
- SE1**
h- 37.5-50 mm
- SE2**
h- 50-75 mm
- SE3**
h- 75-120 mm
- SE4**
h- 120-170 mm
- SE5**
h- 170-215 mm
- SE6**
h- 140-230 mm
- SE7**
h- 185-275 mm
- SE8**
h- 235-325 mm
- SE9**
h- 205-345 mm
- SE10**
h- 250-385 mm
- SE11**
h- 300-400 mm
- SE12**
h- 270-455 mm
- SE13**
h- 315-500 mm
- SE14**
h- 365-550 mm



izonet
HIDROIZOLACIONI SISTEMI

Possibility to conduct and hide different installations without difficulties, during construction and after it.

ETERNO program is used to overcome bigger differences at the height. It varies from 28 to 550 mm.

Unlimited possibilities of interventions like change of paving design, change of installations or recovery of waterproofing below paving.

Head of the adjustable support can be rotated and put in different angle, and that is how we can make floor completely flat although the surface below is under slope.



moldings for concealing the joint of waterproofing and paving



**tiles spacers for aluminum joist
42x42 mm**



**noise insulating rubber for aluminum joist
15x2 mm**



**aluminum joist
60x25 mm/L- 2000mm**



There is an option of installing paving on an aluminum joist as well.

System of open fugues efficiently takes water and there is no need for line drain so it's more economic.

There are no damaged fugues or calcification on the stone paving.

Stone paving is completely flat. Slopes in construction for water drain are hidden. Mobilier stands flat and stable on paving.

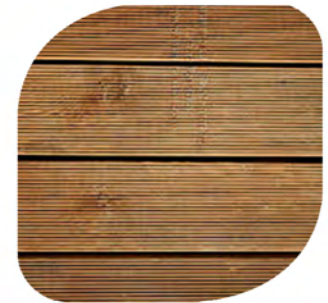
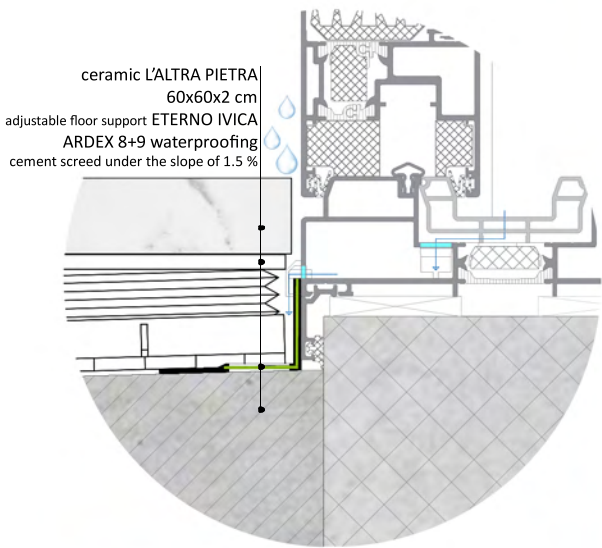

different types of wooden flooring



concrete panels

Beside ceramic and stone paving, on aluminium joist you can also put wooden or concrete floor.

It allows crossing between interior and exterior space with same floor levels – for example, finished floor of the room and terrace are on the same level.

This system allows us to hide threshold (door-step) of the terrace door, so than we can have clean walk line between interior and exterior space, without barriers.



combination of the **pool**



and **ceramic**



set on the **adjustable floor support**



Strong mechanical resistance on impacts.

Excellent solution for pool areas.

Freedom in creating different architectural solutions like combination: pool + green roof + ceramic/stone paving.

Waterproofing is not loaded with other layers that goes over it, which is a case in classic paving systems (for example – ceramics on the adhesive layer).

Because of "air layer", which during the summer cools the surface and during the winter prevent additional cooling, this system is energy efficient.



combination of the **sedum roof**



and **ceramic**



set on **adjustable floor support**



Strong visual effect + simple implementation + economy.

Simplicity in combining different types of final layer.

Space between pavement and construction surface becomes in a significant termic and sound isolation.

The ceramic surface absorbs significantly less heat and cold.

Waterproofing system is not stiff and that is why stone paving system with adjustable support lasts much longer.